

Mini Pop Up Counter Assembly Instructions

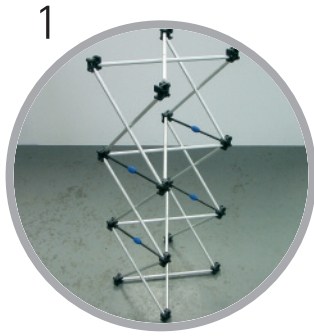

1
Erect structure ensuring blue magnetic connectors snap together.



2
Affix vertical magnetic rails...

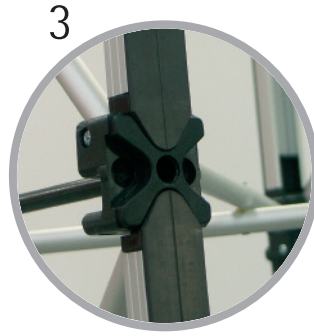

3
into their magnetic locators



4
The rails not only strengthen the structure but will take the graphic wrap

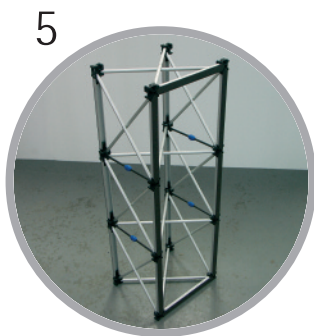

5
The assembled structure should now look like this.



6
Align the vertical graphic edge with the central line on the vertical magnetic rail at the back and affix.

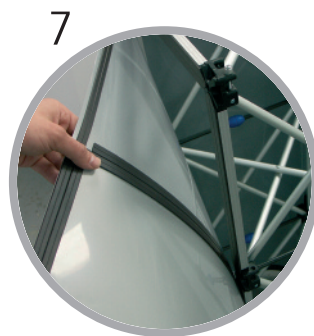

7
Unroll the graphic and work your way round the front of the structure, ensuring the magnetic tape on graphic rear, affixes to exact position on the vertical magnetic rails.



8
Lower the wooden table top onto the four locating studs located on the frame top.



9
Drop the 3 wooden shelves into position within the structure to complete your Mini Pop Up Counter



10
Your counter is now ready for all types of promotional work. To dismantle the pop up counter, reverse the assembly procedure. Ensure graphic is rolled up - image side facing outwards.

